



AAV LED 制照者

普翊电子（东莞）有限公司

PUYI Electronics (Dong guan) Co., Ltd

承认书

Specification for approval



客户名称
(Customer Name)

产品名称
(Product Name)

3838 球头 395 紫外杀菌灯

产品型号
(Product Model)

AAV-TD3838UVA2-A5

客户料号
(Customer part NO)

承认日期
(Accept Date)

■ 特点

- 外观尺寸 (L/W/H) : 3.9*3.9*3.1mm

Outline Dimensions (L / w / h): 2.8 x 3.5 x 0.8 mm

- 发光颜色及胶体: 紫色/透明胶体

Luminous color and colloid: Purple /Transparent colloid

- 高光输出功率

High light output power

- 寿命长, 低光衰

Long life and low light attenuation

- 湿气敏感性等级 (MSL) : 4-5 级

Moisture sensitivity level (MSL) : 4-5 levels

- 环保工艺符合 ROHS 要求

Environmental protection products Complied With ROHS Directive



■ 应用领域

- 杀毒消菌

Disinfect toxin and bacteria

- 空气和水净化

Air and water purification

- 紫外探测与通讯技术

Ultraviolet detection and communication technology

- 食品加工保鲜、食品饮料的包装, 生鲜储存等

Food processing and preservation, packaging of food and beverage, fresh storage, etc

- 医疗卫生, 皮肤病治疗等

Medical health, skin disease treatment, etc





■ 电性参数

● 极限参数 (温度=25℃) :

Absolute Maximum Ratings (Temperature=25° C) :

参数 parameter	数值 Value	单位 Unit
消耗功率 Power Dissipation	4	W
正向电流 Forward current	1000	mA
结温 Junction Temperature	125	°C
抗静电能力 Electrostatic Discharge	3000	V
工作温度 Operation Temperature Range	-40°C to +85°C	
储存温度 Storage Temperature Range	-40°C to +85°C	
焊接温度 Lead Soldering Temperature	255°C ≤ 6S	

● 光电参数 (温度=25℃)

Electro-Optical Characteristics (Temperature=25° C) :

参数名称 Parameter	符号 Symbol	测试条件 Test conditions	最小值 Min	典型值 Typ	最大值 Max	单位 Unit
主波长 Main wavelength	λ_D	IF=500mA	390	—	400	nm
辐射通量 Radiant Flux	PO		1000		1200	mw
正向电压 Forward voltage	VF		3.1	—	3.7	V
发光角度 Viewing Angle	2 θ 1/2		—	60	—	Deg
半波宽 Half wave width	HW		—	13	—	nm
反向电流 Reverse current	IR	VR=5V	—	—	5	μA



● 辐射功率

Radiation Flux grading:

代码 Code	最小值 Minimum value	最大值 Maximum	单位 Company	测试条件 Test conditions
N5	1000	1100	mw	IF=500mA
N6	1100	1200		

● 电压分档

Voltage grading:

代码 Code	最小值 Minimum	最大值 Maximum	单位 Company	测试条件 Test conditions
R21-3	3.1	3.4	V	IF=500mA
R24-3	3.4	3.7		

● 波长分档

Wavelength grading:

代码 Code	最小值 Minimum	最大值 Maximum	单位 Company	测试条件 Test conditions
SZ06	390	400	nm	IF=500mA



■ 典型特性曲线

·Forward Voltage vs. Forward Current

$T_a=25^\circ\text{C}$

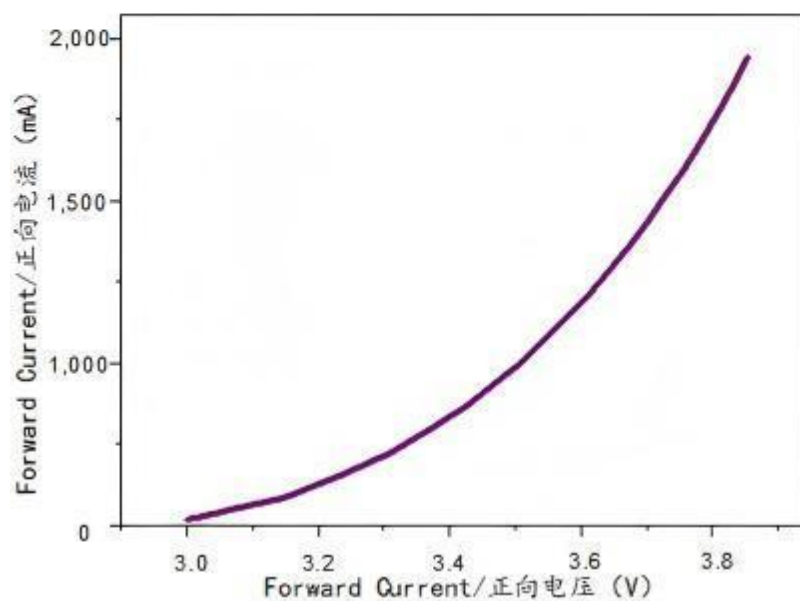

·Spectrum

$T_a=25^\circ\text{C}$, $I_f=500\text{mA}$

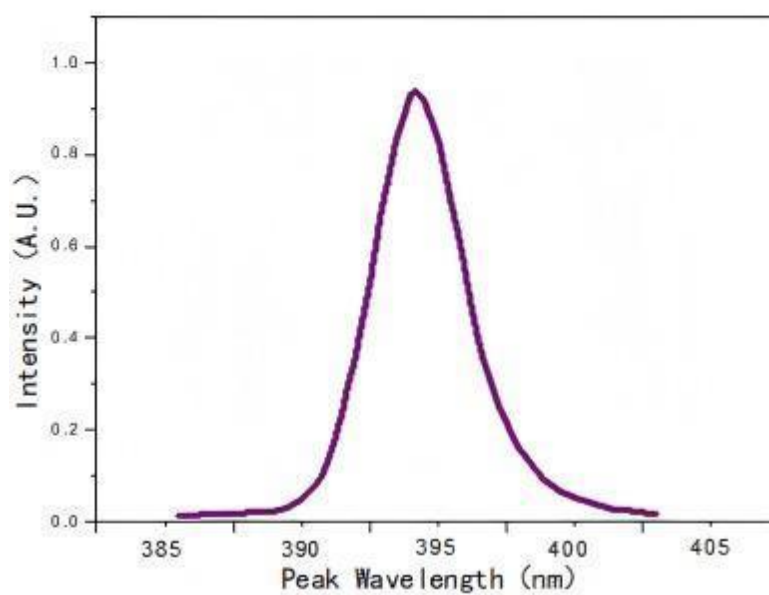



■ 可靠性实验项目

描述 Description	项目 Item	测试标准 Testcriterion	测试条件 Testcondition	测试时间 Testtime	数量 Qty	失效数量 Failqty
寿命测试 Lifetest	常温寿命测试 Lifetest (room temperature)	JIS7021:B4	Ta=25℃±5℃, IF=1000mA	1000Hrs	22	0
环境测试 Ambience test	高温存储 Hightemperatu restore	JIS7021:B10 MIL-STD-202:210A MIL-STD-750:2031	Ta=85℃±5℃	1000Hrs	22	0
	低温存储 Low temperature store	JIS7021:B12	Ta=-35℃±5℃	1000Hrs	22	0
	高温高湿测试 High temperature/humidity test	JIS7021:B11 MIL-STD-202:103D	Ta=85℃±5℃ RH=85%	1000Hrs	22	0
	冷热冲击测试 Cold / Heat strike test	JIS7021::B4 MIL-STD-202:107D MIL-STD-750:1026	30min -10℃±5℃←→100℃±5℃ 5min 5min	50Cycles	22	0
	冷热循环测试 Cold and heat cycle test	JIS7021:A3 ML-STD-202:107D MIL-STD-705:105E	5min 5min 5min -35℃~25℃~85℃ ~ -35℃ 30min 5min 30min 5min	50Cycles	22	0

● 判断标准

Judging criterion:

项目 Item	符号 Symbol	实验条件 Experiment condition	判断标准 Criteria	
			Min.	Max.
Forward Voltage 正向电压	VF	IF=1000mA	----	Initial Datex1.1
Reverse Current 反向电流	IR	VR=5V	----	5 μA
Luminous Intensity 发光强度	IV	IF=60mA	Initial Datex0.7	----



■ 外形尺寸

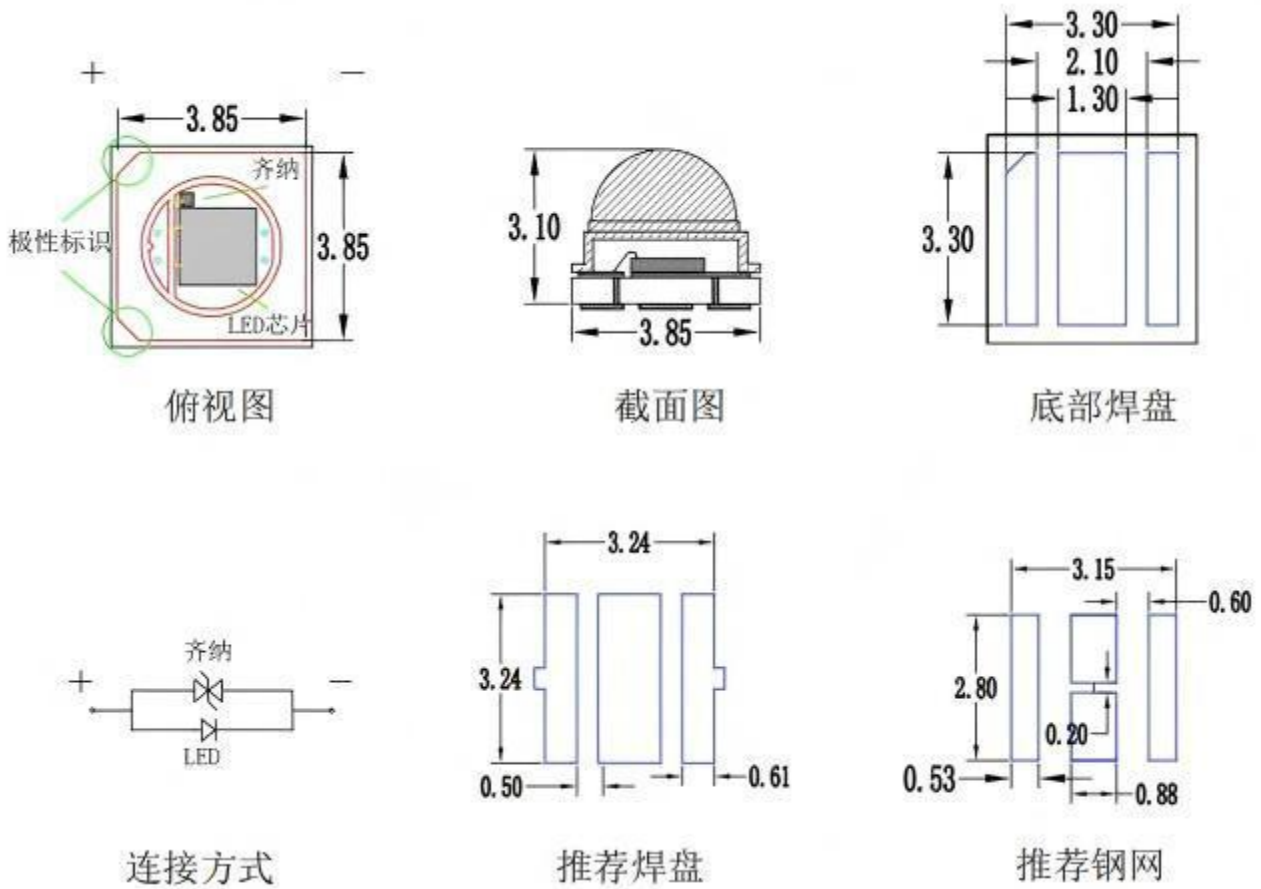

备注:

Remarks:

1. 以上尺寸单位均为 mm
1. All dimensions are in millimeters.
2. 未特别标注公差尺寸公差均为 $\pm 0.25\text{mm}$
2. Tolerance is $\pm 0.25\text{mm}$ unless otherwise noted



■ 包装(1)

● 载带与圆盘尺寸

Belt and disk dimensions

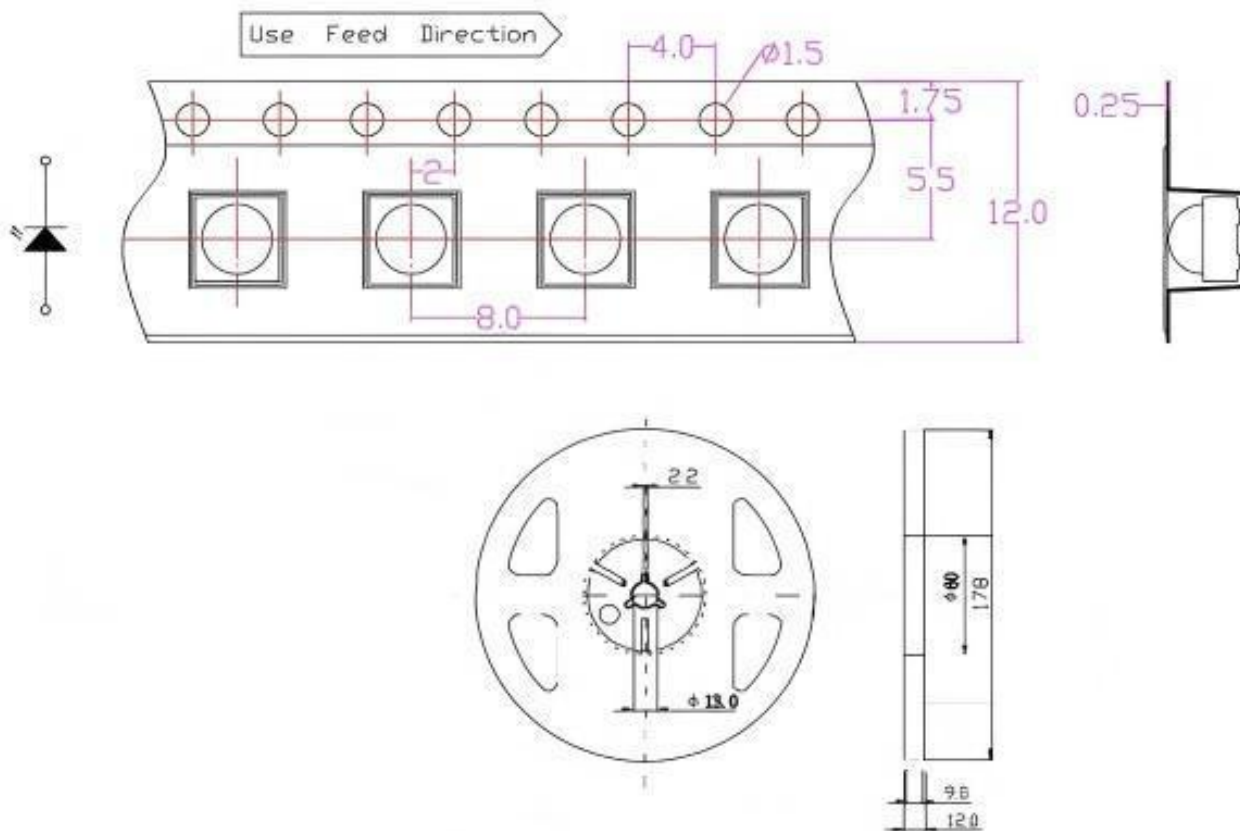

注 (Note):

1. 尺寸单位为毫米(mm)。
1. Size unit is mm (mm).
2. 尺寸公差是 ± 0.1 mm。
2. The dimensional tolerance is ± 0.1 mm.

● 圆盘及载带卷出方向及空穴规格

Disk and carrier belt direction of roll and hole dimensions

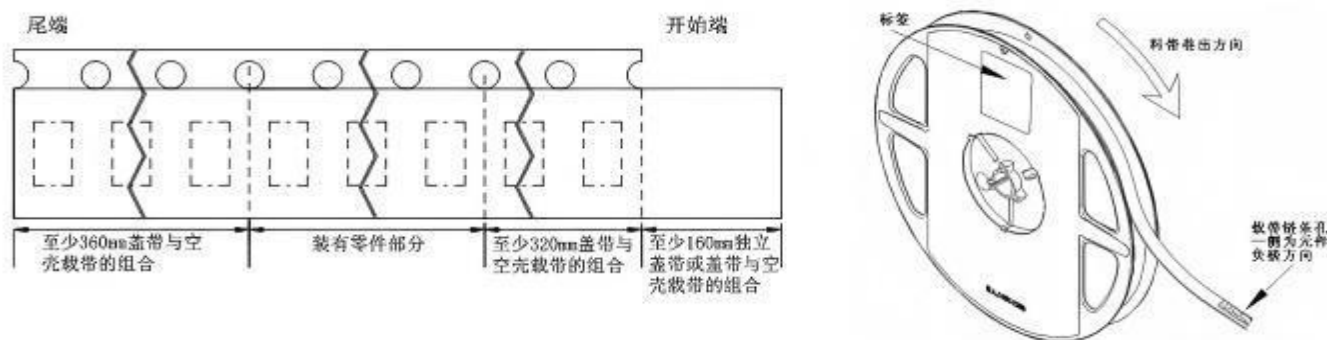



■ 包装(2)

◇ 防潮抗静电包装 Moisture Proof and Anti-Electrostatic Foil Bag

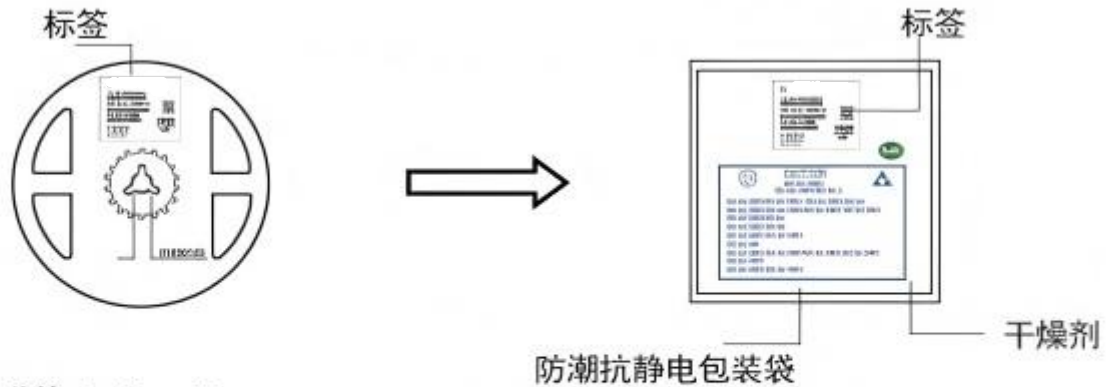

◇ 外包装箱 Cardboard Box

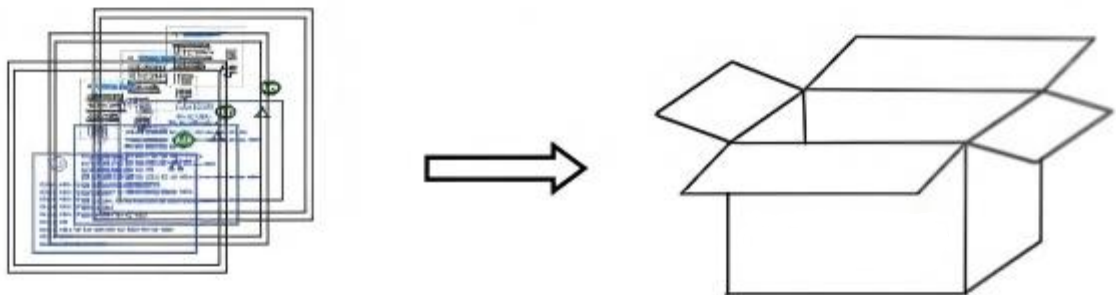

Capacity 5 or 10 reels per box (内箱容量: 50或100卷)

◇ 标签说明: Label Explanation

LOT NO: 批次信息

PART NO: 产品型号

BIN CODE: 产品名称

WL: 波长范围

IV: 光强范围

VF: 电压范围

■ 焊接指导(1)

● 使用烙铁人手焊接

- ◆ 只建议在修理和重工的情况下使用手工焊接；推荐使用功率低于 30 W 的烙铁，焊接时烙铁的温度必须保持在 300℃ 以下，且每个电极只能进行一次焊接，每次焊接的持续时间不得超过 3 秒。人手焊接过程中的不慎操作易引起 LED 产品的损坏，应当小心谨慎。

Manual welding is recommended only for repair and heavy industry situations. A soldering iron of less than 30W is recommended to be used in Hand Soldering. Please keep the temperature of the soldering iron under 300℃ while soldering. Each terminal of the LED is to go for less than 3 second and for one time only.

Be careful because the damage of the product is often started at the time of the hand soldering.

● 回流焊接

- ◆ 推荐使用以下无铅回流焊接温度图进行。

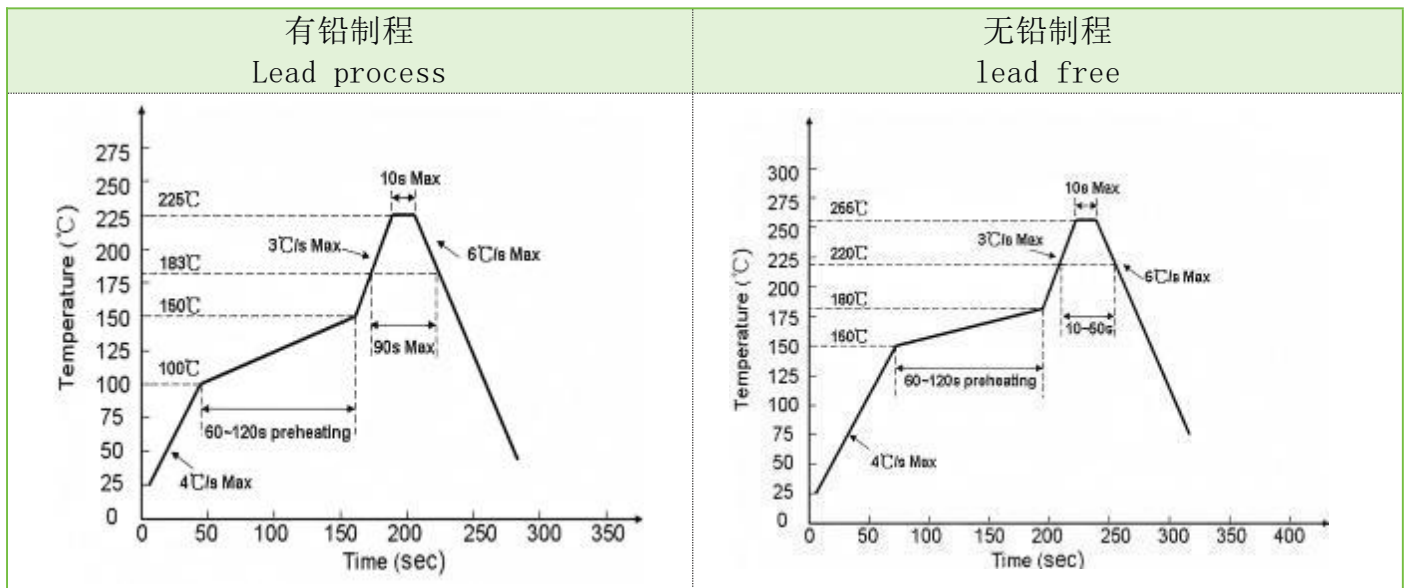

- ◆ 回流焊接最多只能进行两次。

Reflow soldering should not be done more than two times.

- ◆ 在回流焊接升温过程中，请不要对 LED 施加任何压力。

Stress on the LEDs should be avoided during heating in soldering process.

- ◆ 在焊接完成后，待产品温度下降到室温之后，再进行其他处理。

After soldering, do not deal with the product before its temperature drop down to room temperature.

■ 焊接指导(2)

● 清洗

- ◆ 在焊接后推荐使用酒精进行清洗，在温度不高于 30℃的条件下持续 3 分钟，不高于 50℃的条件下持续 30 秒。使用其他类似溶剂清洗前，请先确认使用的溶剂不会对 LED 的封装和环氧树脂部分造成损伤。

It is recommended that alcohol be used as a solvent for cleaning after soldering. Cleaning is to go under 30℃ for 3 minutes or 50℃ for 30 seconds. When using other solvents, it should be confirmed beforehand whether the solvents will dissolve the package and the resin or not. Ultrasonic cleaning is also an effective way for cleaning. But the influence of Ultrasonic cleaning on LED depends on factors such as ultrasonic power. Generally, the ultrasonic power should not be higher than 300W. Before cleaning, a pretest should be done to confirm whether any damage to LEDs will occur.

- ◆ 超声波清洗也是有效的方法，一般最大功率不应超过 300W，否则可能对 LED 造成损伤。请根据具体的情况预先测试清洗条件是否会对 LED 造成损伤。

Ultrasonic cleaning is also an effective way for cleaning. But the influence of Ultrasonic cleaning on LED depends on factors such as ultrasonic power. Generally, the ultrasonic power should not be higher than 300W. Before cleaning, a pretest should be done to confirm whether any damage to LEDs will occur.

- ❖ 注意：此一般指导原则并不适用于所有 PCB 设计和焊接设备的配置。具体工艺受到诸多因素的影响，请根据特定的 PCB 设计和焊接设备来确定焊接方案。
- ❖ Note: his general guideline may not apply to all PCB designs and configurations of all soldering equipment. The technics in practise is influenced by many factors, it should be specialized base on the PCB designs and configurations of the soldering equipment..

■ 使用注意事项(1)

● 贮存

- ◆ 本产品使用密封防潮抗静电袋包装，并附有干燥剂，未开封的产品有一年的保存时间。

Moisture proof and anti-electrostatic package with moisture absorbent material is used, to keep moisture to a minimum.

- ◆ 开封前，产品须存放在温度不高于 30℃，湿度不高于 60%RH 的环境中。

Before opening the package, the product should be kept at 30℃ or less and humidity less than 60% RH, and be used within a year.

- ◆ 开封后，产品须存放在温度不高于 30℃，湿度不高于 10%RH 的环境中，且应该在 168 小时（7 天）内使用完。建议工作环境为温度不高于 30℃，湿度不高于 60%RH。

After opening the package, the product should be stored at 30℃ or less and humidity less than 10%RH, and be soldered within 168 hours (7 days). It is recommended that the product be operated at the workshop condition of 30℃ or less and humidity less than 60%RH

- ◆ 对于尚未焊接的 LED，如果吸湿剂或包装失效，或者产品没有符合以上有效存储条件，烘焙可以起到一定的性能恢复效果。烘焙条件：60(±5)℃，持续 24 小时。

If the moisture absorbent material has fade away or the LEDs have exceeded the storage time, baking treatment should be performed based on the following condition: 60(±5)℃ for 24 hours.

■ 使用注意事项(2)

● 静电

- ◆ 静电和电涌会导致产品特性发生改变，例如正向电压降低等，如果情况严重甚至会损毁产品。所以在使用时必须采取有效的防静电措施。所有相关的设备和机器都应该正确接地，同时必须采取其他防止静电和电涌的措施。使用防静电手环，防静电垫子，防静电工作服、工作鞋、手套，防静电容器，都是有效的防止静电和电涌的措施。

Static electricity or surge voltage damages the LEDs. Damaged LEDs will show some unusual characteristic such as the forward voltage becomes lower, or the LEDs do not light at the low current. even not light.

All devices, equipment and machinery must be properly grounded. At the same time, it is recommended that wrist bands or anti-electrostatic gloves, anti-electrostatic containers be used when dealing with the LEDs.

● 设计建议

- ◆ 设计电路时，通过 LED 的电流不能超过规定的最大值，同时，还需使用保护电阻，否则，微小的电压变化将会引起较大的电流变化，可能导致产品损毁。

In designing a circuit, the current through each LED must not exceed the absolute maximum rating specified for each LED. In the meanwhile, resistors for protection should be applied, otherwise slight voltage shift will cause big current change, burn out may happen.

- ◆ 建议使用以下 (A) 电路，该电路能够很好的调节通过每个 LED 的电流；不推荐使用 (B) 电路，该电路在持续的电压驱动下，LED 的正向电压 (V_F) 发生变化，电流会随之而发生变化，可能使某些 LED 承受高于规定的电流值。

It is recommended to use Circuit A which regulates the current flowing through each LED rather than Circuit B. When driving LEDs with a constant voltage in Circuit B, the current through the LEDs may vary due to the variation in Forward Voltage (V_F) of the LEDs. In the worst case, some LED may be subjected to stresses in excess of the Absolute Maximum Rating.

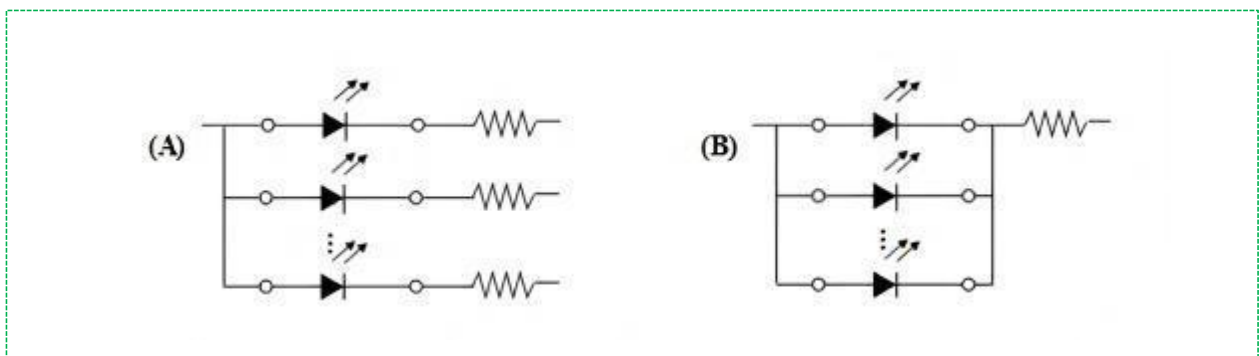

- ◆ LED 的特性容易因为自身的发热和环境的温度的改变而发生改变。温度的升高会降低 LED 的发光效率、影响发光颜色等，所以在设计时应充分考虑散热的问题。

Thermal Design is paramount importance because heat generation may result in the Characteristics decline, such as brightness decreased, Color changed and so on. Please consider the heat generation of the LEDs when making the system design.

■ 使用注意事项(3)

● 其他事项

- ◆ 直接用手拿取产品不但会污染封装树脂表面，也可能由于静电等因素导致产品性能的改变。过度的压力也可能直接影响封装内部的管芯和金线，因此请勿对产品施加过度压力，特别当产品处于高温状态下，例如在回流焊接过程中。

When handling the product, touching the encapsulant with bare hands will not only contaminate its surface, but also affect on its optical characteristics. Excessive force to the encapsulant might result in catastrophic failure of the LEDs due to die breakage or wire deformation. For this reason, please do not put excessive stress on LEDs, especially when the LEDs are heated such as during Reflow Soldering.

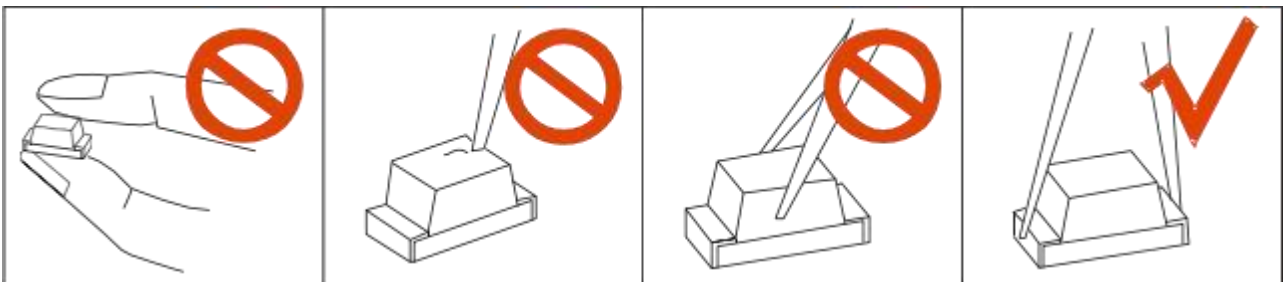

- ◆ LED 的环氧树脂封装部分相当脆弱，请勿用坚硬、尖锐的物体刮、擦封装树脂部分。在用镊子夹取的时候也应当小心注意。

The epoxy resin of encapsulant is fragile, so please avoid scratch or friction over the epoxy resin surface. While handling the product with tweezers, do not hold by the epoxy resin, be careful.

● 眼睛保护忠告

- ◆ LED 发光时，请勿直视发光光源，特别是对于一些光强较高的 LED，强光可能伤害你的眼睛。

Viewing direct to the light emitting center of the LEDs, especially those of great Luminous Intensity, will cause great hazard to human eyes. Please be careful.



■ 版本更新

修订次数	修订内容	修订日期	修订人	版次
1	新建文件	2023-6-13	汤叶飞	A/0